

TOWN OF BRAINTREE

IN COUNCIL

ORDER NO: **11-009**

DATE: March 10, 2011

ORDERED: NATIONAL GRID

PETITION OF NATIONAL GRID FOR GAS MAIN LOCATIONS

The National Grid hereby respectfully request your consent to the locations of mains as hereinafter described for the transmission and distribution of gas in and under the following public streets, lanes, highways, and places of the Town of Braintree and the pipes, valves, governors, manholes and other structures, fixtures and appurtenances designed or intended to protect or operate said mains and accomplish the objects of said Company; and the digging up and opening the ground to lay or place same:

To install and maintain approximately 240 feet, more or less of 2 inch gas main in Brow Avenue, Braintree.

From the existing 2 inch gas main in Academy Street Northerly to House #16. All of which to replace and abandon the existing 2 inch gas main in Brow Avenue, Braintree

Petition #11 009 was unanimously approved by Council with the following conditions:

DPW: Hancock Street in that area is State Highway and a MassDOT permit will be required. This petition is **approved with our "standard" conditions and with the conditions of MassDOT's permit incorporated into the Town approval.**

Passed in Council – April 5, 2011

A True Copy, Attest:



Joseph F. Powers, Town Clerk

YEAS: Bowes, Clifford, DeNapoli, Dingee, Joyce, Kokoros, Mullaney, Powers, Ryan

NAYS: Bowes, Clifford, DeNapoli, Dingee, Joyce, Kokoros, Mullaney, Powers, Ryan

ABSENT: Bowes, Clifford, DeNapoli, Dingee, Joyce, Kokoros, Mullaney, Powers, Ryan

PETITION OF NATIONAL GRID FOR GAS MAIN LOCATIONS

Town of Braintree/ Board of Selectmen:-

The Nationalgrid hereby respectfully requests your consent to the locations of mains as hereinafter described for the transmission and distribution of gas in and under the following public streets, lanes, highways, and places of the **Town of Braintree** and of the pipes, valves, governors, manholes and other structures, fixtures and appurtenances designed or intended to protect or operate said mains and accomplish the objects of said Company; and the digging up and opening the ground to lay or place same:

To install and maintain approximately 240 feet, more or less of 2 inch gas main in Brow Avenue, Braintree.

From the existing 2 inch gas main in Academy Street Northerly to House # 16. All of which to replace and abandon the existing 2 inch gas main in Brow Avenue, Braintree

DATE March 11, 2011

BY 
Dennis K. Regan
Permit Representative

ORDER FOR GAS MAIN LOCATION

Town of Braintree / Board of Selectmen:

IT IS HEREBY ORDERED that the locations of the mains of the Nationalgrid for the transmission and distribution of gas in and under the public streets, lanes, highways, and places of the **Town of Braintree** substantially as described in the petition dated March 11, 2011 attached hereto and hereby made a part hereof, and of the pipes, valves, governors, manholes and other structures, fixtures and appurtenances designed or intended to protect or operate said mains and/or accomplish the objects of said Company, and the digging up and opening the ground to lay or place same, are hereby consented to and approved.

The said Nationalgrid shall comply with all applicable provisions of law and ordinances of the **Town of Braintree** applicable to the enjoyment of said locations and rights.

Dated this _____ day of _____, 20 ____.

I hereby certify that the foregoing order was duly adopted by the _____ of the City of _____, MA on the _____ day of _____, 20 ____.

BY _____

Title

MN # 144-8502-763753

**RETURN ORIGINAL TO THE PERMIT SECTION
NATIONALGRID
52 SECOND AVENUE, WALTHAM, MA 02451
RETAIN DUPLICATE FOR YOUR RECORDS**

- PRESSURE GAUGES ARE REQUIRED AT ALL TIE-INS. REFER TO GCON-7010 PROCEDURE.
- CHECK ELECTRONIC MAPPING SYSTEM FOR MOST CURRENT MAPPING INFORMATION.

#11-009

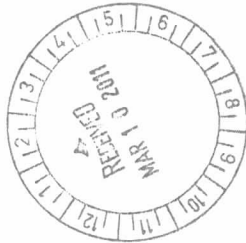

Relay of appr. 240 feet of 2 inch, 60 psig coated steel to the east 2 inch plastic at Academy St to the east 4 inch plastic at #25

Tie into 4 inch plastic

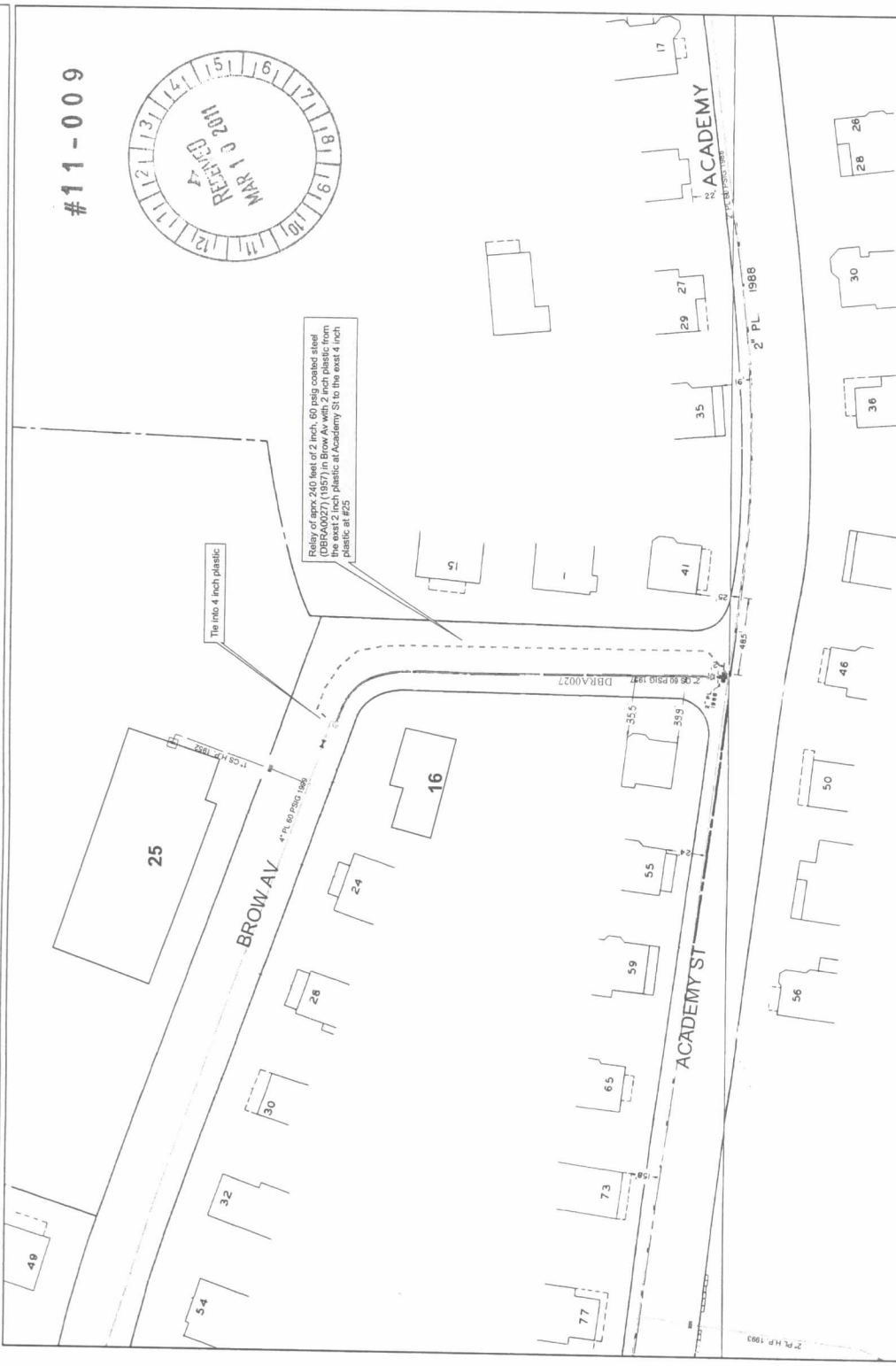

ENGINEERING DESIGN - Proposed Scope of Work

1-16 BROW AV, BRA

As part of the 2011 ACE 107 BSCSW Program, Asset Replacement recommends the relay of appr. 240 feet of 2 inch, 60 psig coated steel (1957) in Brow Av with 2 inch plastic from the east 2 inch plastic at Academy St to the east 4 inch plastic at #25

ENGINEER	CLAU	SIZE	2 inch	AcCFM
DATE	02/07/2011	MATERIAL	Plastic	nationalgrid
LENGTH	240'	PRESSURE	60 PSIG	
SECTIONALS	BRA-T1530	WORK ORDER #	763753	
NOTE: The location of surface and underground objects shown are not warranted to be correct.				

